

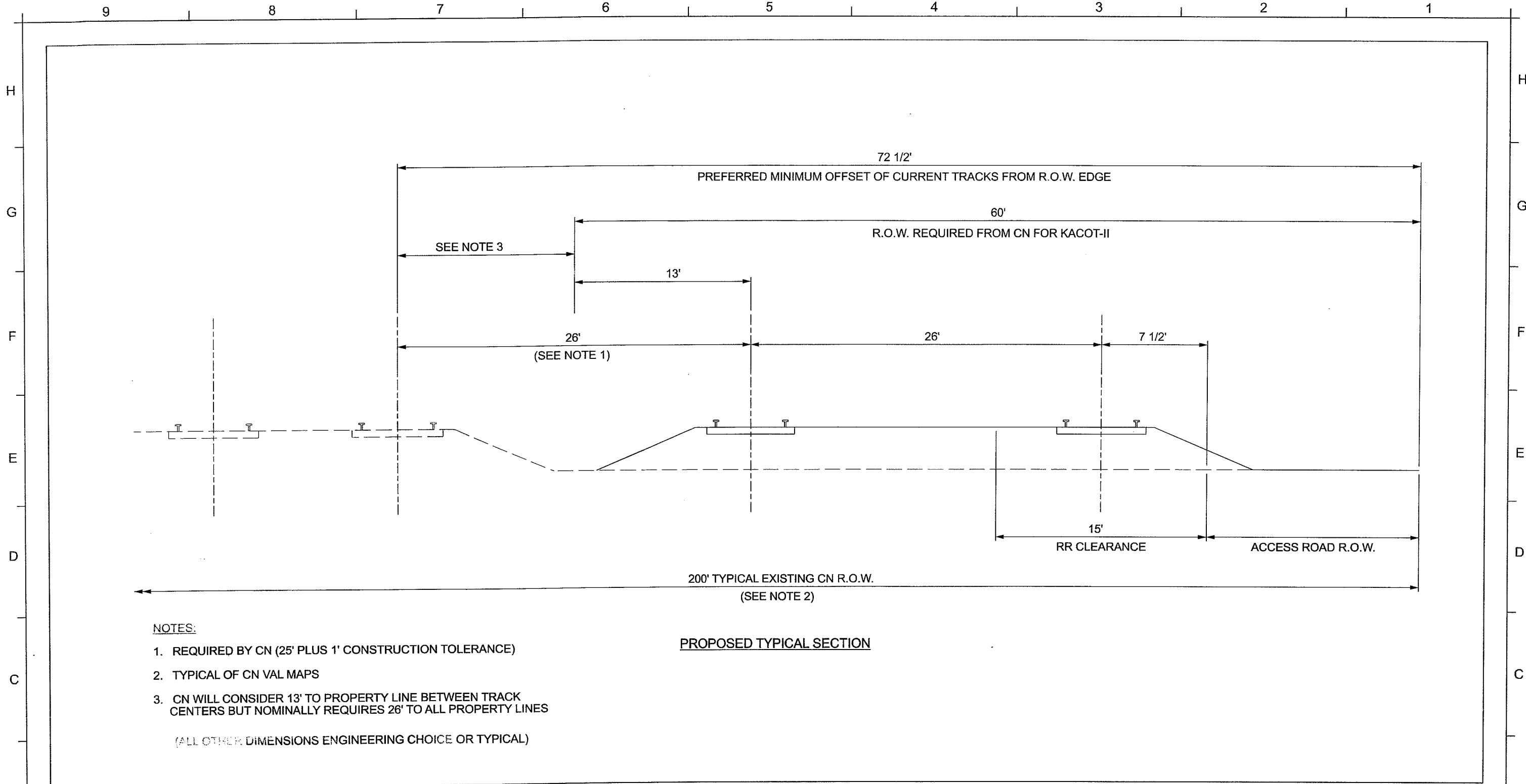

**APPENDIX 5A**

**INDEPENDENT RAIL ALTERNATIVE  
TYPICAL CROSS SECTION AND TRACK SCHEMATICS**

© Copyright 2007 Earth Tech



- NOTES:**
1. REQUIRED BY CN (25' PLUS 1' CONSTRUCTION TOLERANCE)
  2. TYPICAL OF CN VAL MAPS
  3. CN WILL CONSIDER 13' TO PROPERTY LINE BETWEEN TRACK CENTERS BUT NOMINALLY REQUIRES 26' TO ALL PROPERTY LINES
- (ALL OTHER DIMENSIONS ENGINEERING CHOICE OR TYPICAL)

L:\WORK\95214\CADD\Drawings\KACOT-TYP1.dgn

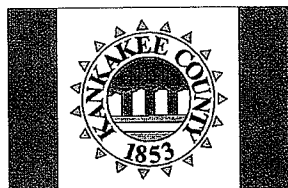

KEY PLAN

PROJECT NAME:  
**KANKAKEE COUNTY COMMUTER  
 TRANSIT PHASE II  
 FEASIBILITY STUDY(KACOT-II)**

SHEET TITLE:  
**TYPICAL CROSS-SECTION  
 OF INDEPENDANT RAIL ALTERNATIVE  
 ON CN RIGHT-OF-WAY**

DESIGNED: JCL      DRAWN: REB      CHECKED: DAG

SCALE: NOT TO SCALE

PROJECT NO.: 95214  
 DATE: 6/18/2007

SHEET NO. <b>1</b>	TOTAL SHEETS <b>1</b>
-----------------------	--------------------------

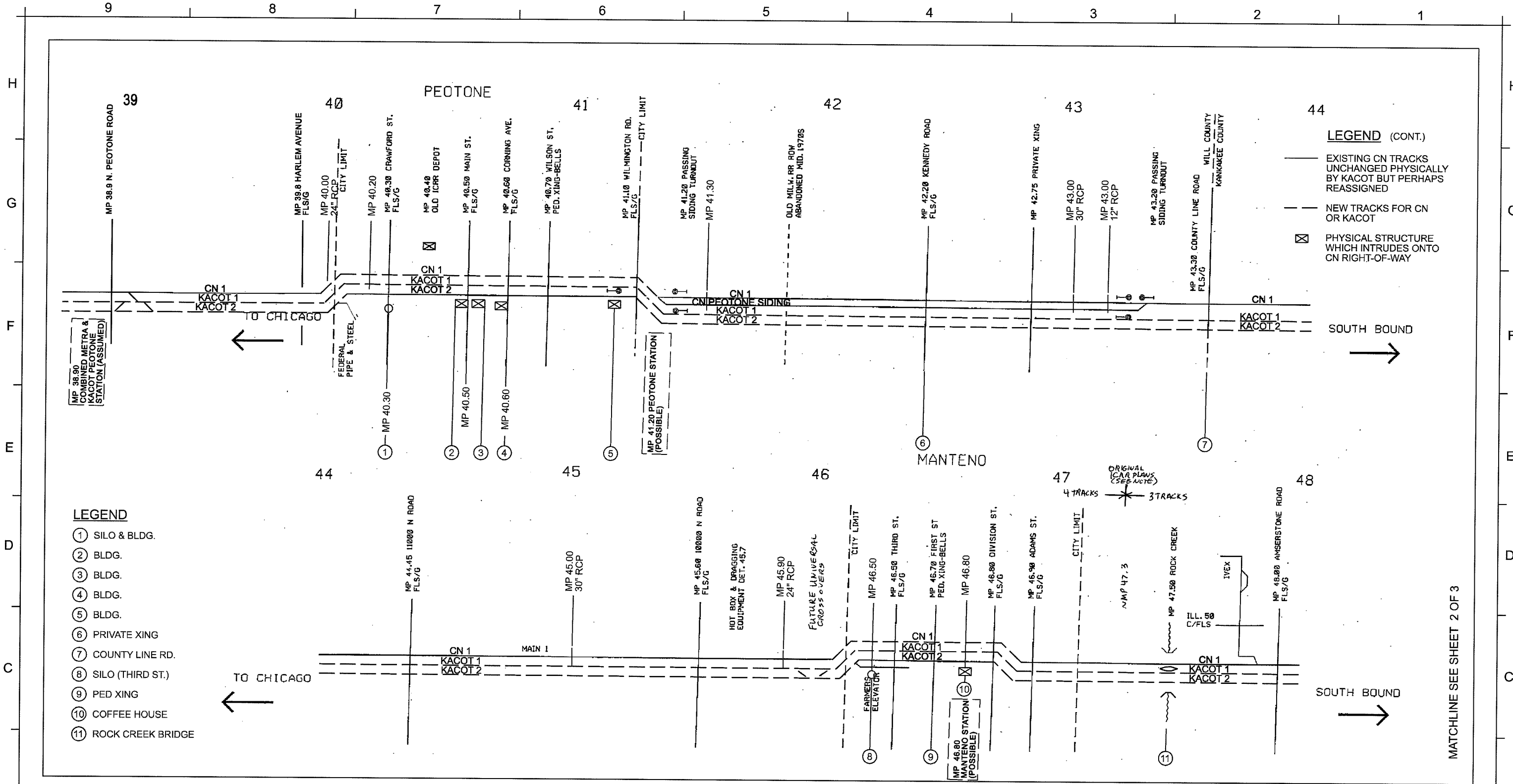

**LEGEND (CONT.)**

- EXISTING CN TRACKS UNCHANGED PHYSICALLY BY KACOT BUT PERHAPS REASSIGNED
- - - NEW TRACKS FOR CN OR KACOT
- ☒ PHYSICAL STRUCTURE WHICH INTRUDES ONTO CN RIGHT-OF-WAY

**LEGEND**

- ① SILO & BLDG.
- ② BLDG.
- ③ BLDG.
- ④ BLDG.
- ⑤ BLDG.
- ⑥ PRIVATE XING
- ⑦ COUNTY LINE RD.
- ⑧ SILO (THIRD ST.)
- ⑨ PED XING
- ⑩ COFFEE HOUSE
- ⑪ ROCK CREEK BRIDGE

NOTE: ORIGINAL ICRR TRACKS SURMISED FROM ERASURE MARKS ON CURRENT VAL MAPS.

KEY PLAN

PROJECT NAME:  
**KANKAKEE COUNTY COMMUTER  
 TRANSIT PHASE II  
 FEASIBILITY STUDY(KACOT-II)**

SCALE:  
 NOT TO SCALE

SHEET TITLE:  
**TRACK SCHEMATIC  
 INDEPENDANT RAIL ALTERNATIVE  
 CN MP 38.9 TO MP 48**

DESIGNED: JCL DRAWN: REB CHECKED: DAG

PROJECT NO.: 95214  
 DATE: 6/18/2007

SHEET NO. <b>1</b>	TOTAL SHEETS <b>3</b>
-----------------------	--------------------------

MATCHLINE SEE SHEET 2 OF 3

© Copyright 2007 Earth Tech

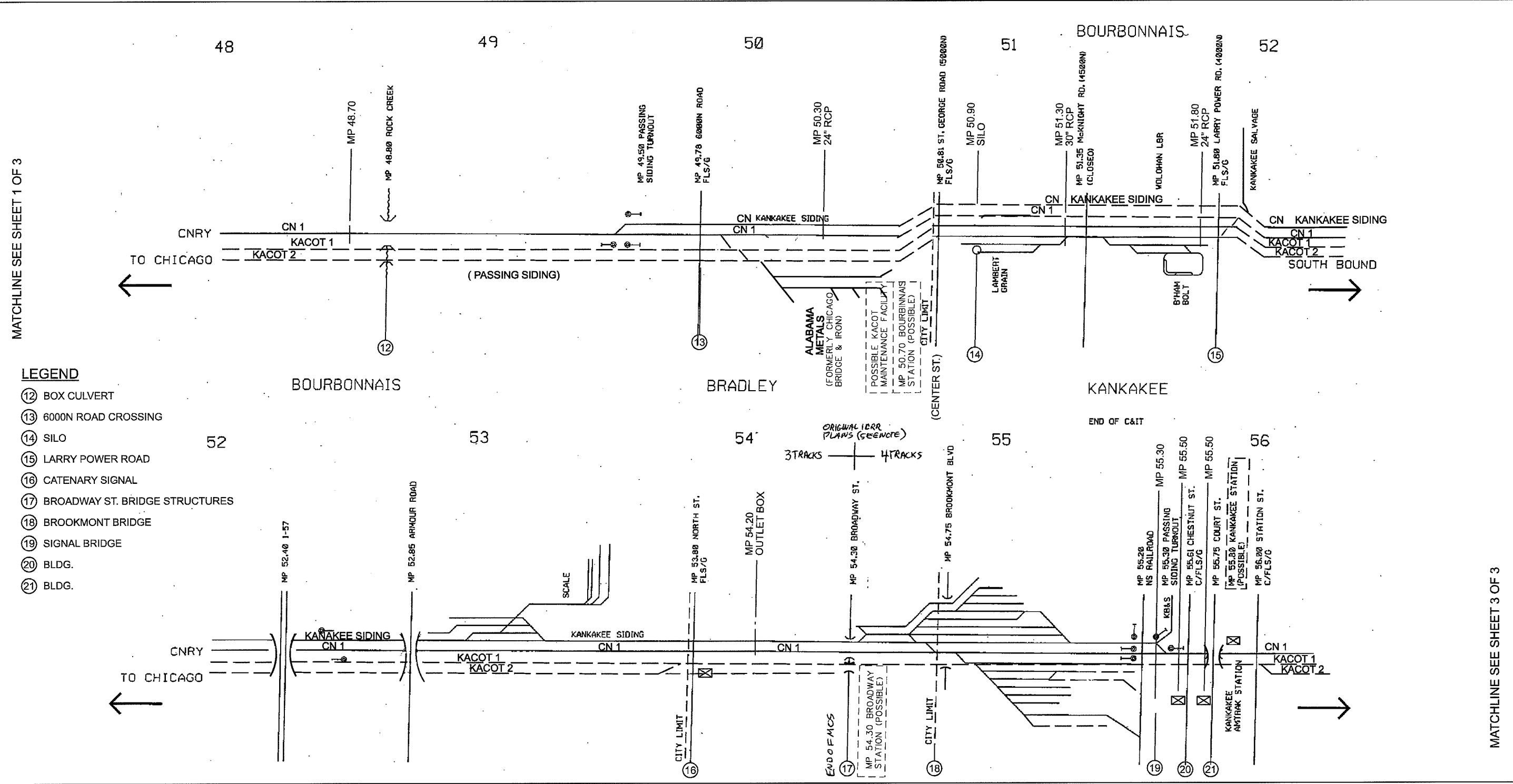

**LEGEND**

- 12 BOX CULVERT
- 13 6000N ROAD CROSSING
- 14 SILO
- 15 LARRY POWER ROAD
- 16 CATENARY SIGNAL
- 17 BROADWAY ST. BRIDGE STRUCTURES
- 18 BROOKMONT BRIDGE
- 19 SIGNAL BRIDGE
- 20 BLDG.
- 21 BLDG.

MATCHLINE SEE SHEET 1 OF 3

MATCHLINE SEE SHEET 3 OF 3

L:\WORK\8214\CADD\Drawings\KACOT\PROP\_46-56.dgn  
A5A-3

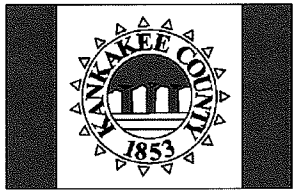

KEY PLAN

PROJECT NAME:  
**KANKAKEE COUNTY COMMUTER  
 TRANSIT PHASE II  
 FEASIBILITY STUDY(KACOT-II)**

SHEET TITLE:  
**TRACK SCHEMATIC  
 INDEPENDANT RAIL ALTERNATIVE  
 CN MP 48 TO MP 56**

SCALE: NOT TO SCALE

DESIGNED: JCL    DRAWN: REB    CHECKED: DAG  
 PROJECT NO.: 95214  
 DATE: 6/18/2007

SHEET NO. <b>2</b>	TOTAL SHEETS <b>3</b>
-----------------------	--------------------------

**LEGEND**

- ② KANKAKEE RIVER BRIDGE
- ③ HAWKINS ST. VIADUCT
- ④ GAR CREEK BRIDGE
- ⑤ SOUTH TECH DRIVE

MATCHLINE SEE SHEET 2 OF 3

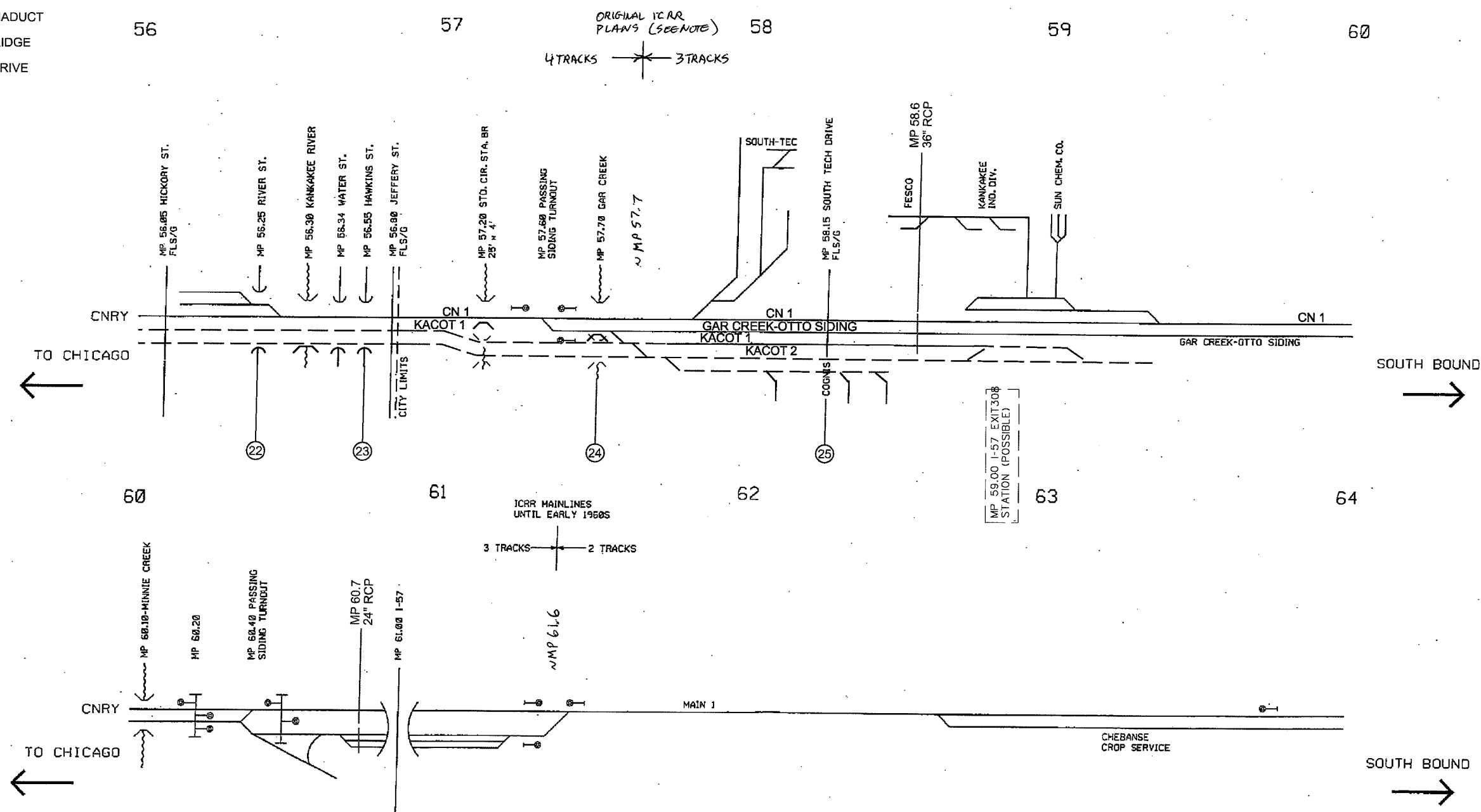

L:\WORK\95214\ICADD\Drawings\KACOT\FRCP\_55-64.dgn  
A5A-4

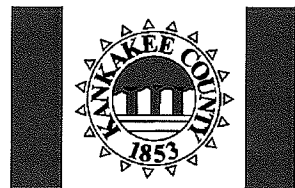

KEY PLAN

PROJECT NAME:  
**KANKAKEE COUNTY COMMUTER  
TRANSIT PHASE II  
FEASIBILITY STUDY(KACOT-II)**

SHEET TITLE:  
**TRACK SCHEMATIC  
INDEPENDANT RAIL ALTERNATIVE  
CN MP 56 TO MP 60**

DESIGNED: JCL  
DRAWN: REB  
CHECKED: DAG

PROJECT NO.: 95214  
DATE: 6/18/2007

SCALE:  
NOT TO SCALE

SHEET NO. <b>3</b>	TOTAL SHEETS <b>3</b>
-----------------------	--------------------------